

NUI COMPACT CHEST COMPRESSION DEVICE

- it's all about depth

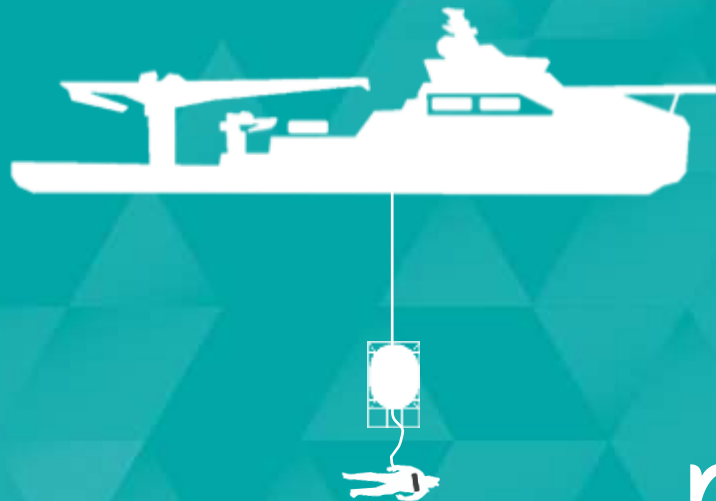
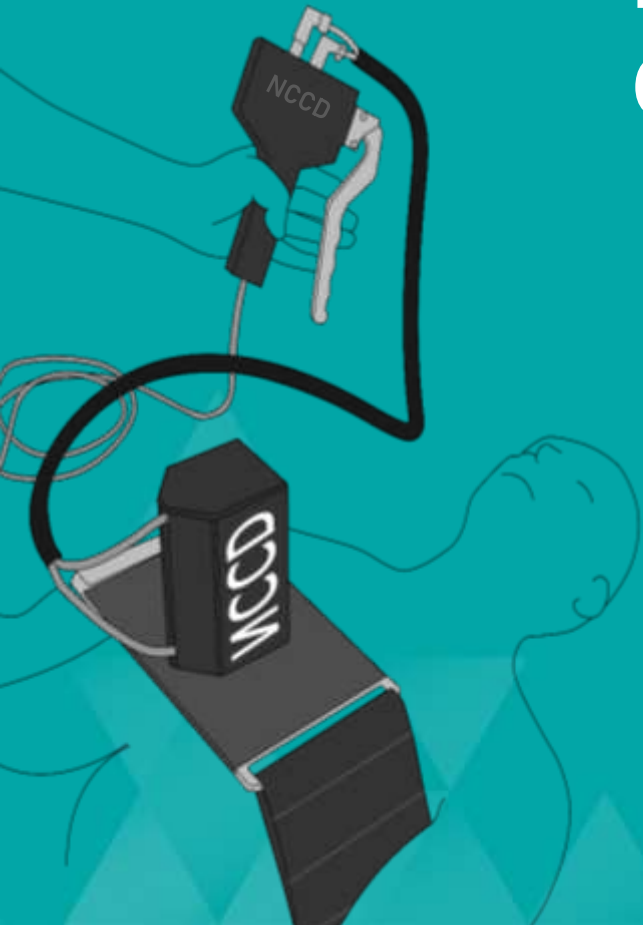

nui

Funding of development





Bergen International Diving Seminar 2019

Challenges when performing CPR in a diving bell

- Narrow working conditions
- Exhausting over time
- Limited number of first aid personnel
- Vertical patient (diver)
- Insufficient current methods

NUI COMPETENCE

- Emergency medicine
- Saturation diving
- Subsea operations
- Engineering
- Chemistry
- HSEQ



To the drawing board

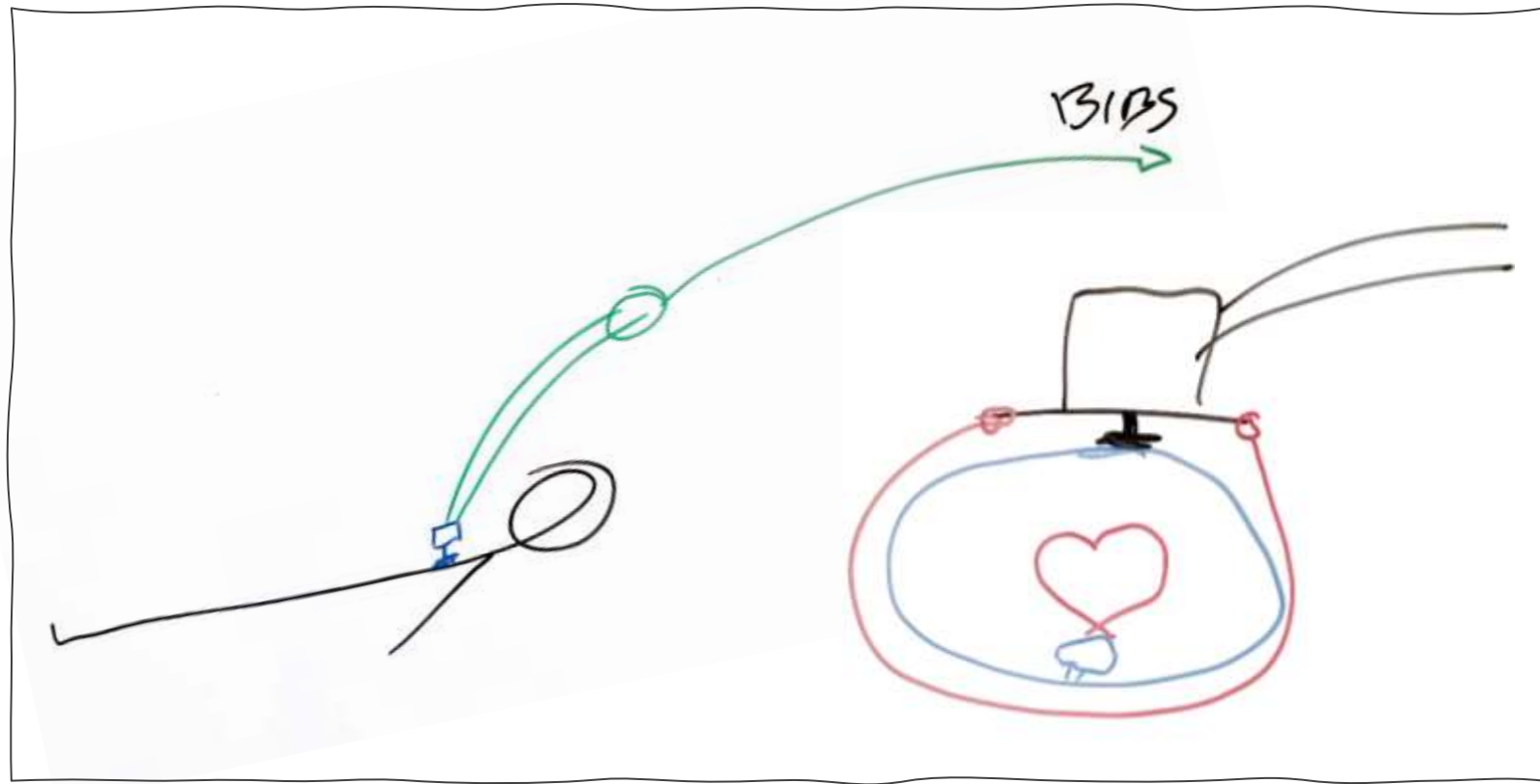

hyperbaric compartments

-

12M DEVELOPMENT

- Chest belt
- Compression unit
- Hand control unit

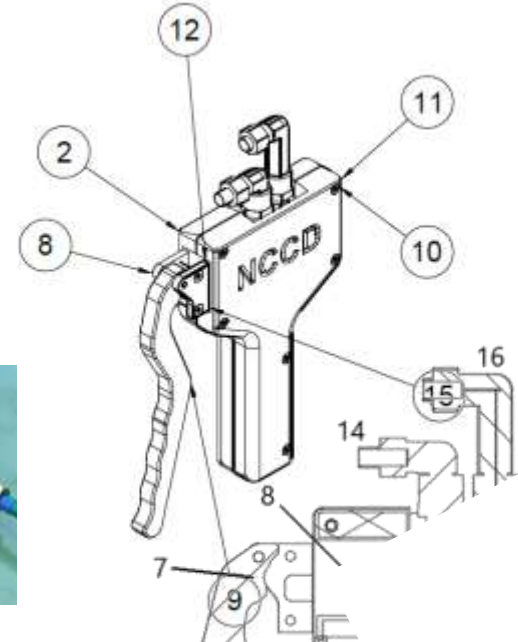

NUI LAB

Full scale hyperbaric offgass testing

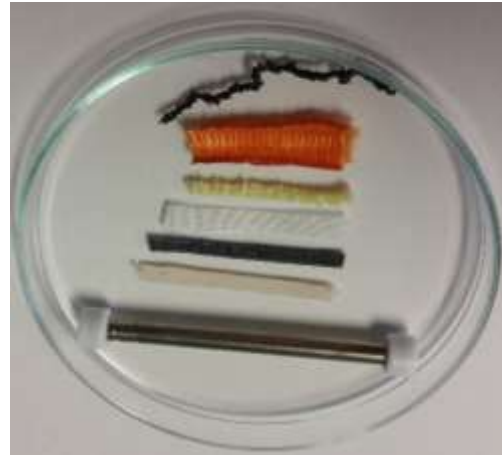

NORSOK
U-100



nui



500 kg



2x length



3x drive pressure





Operating sound level reduction



<80 dB

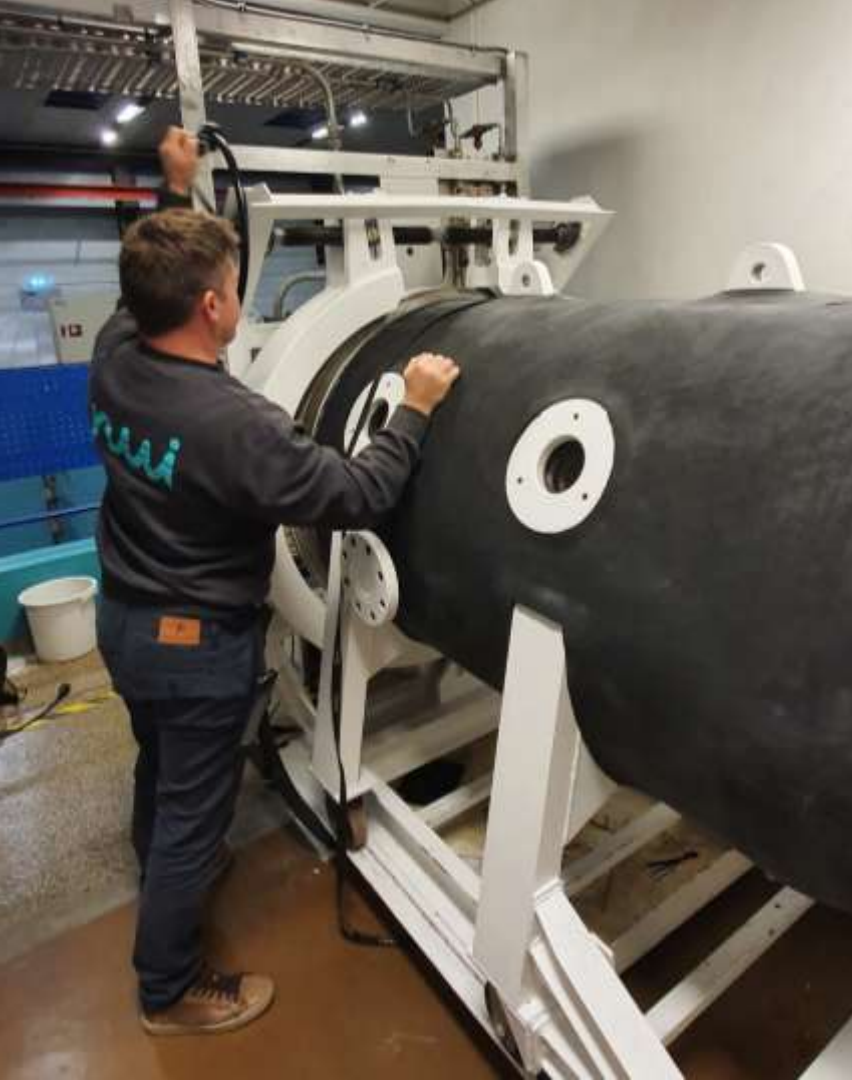

Hyperbaric function
testing in heliox 2%

350 msw / 35 bar / 3.5 kPa





Test
submerged
in water

Successful



User tests

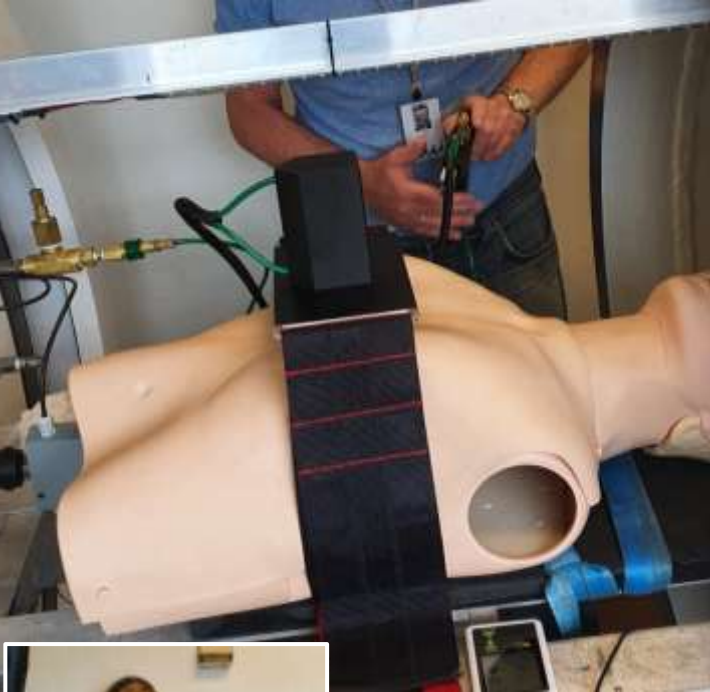

Result

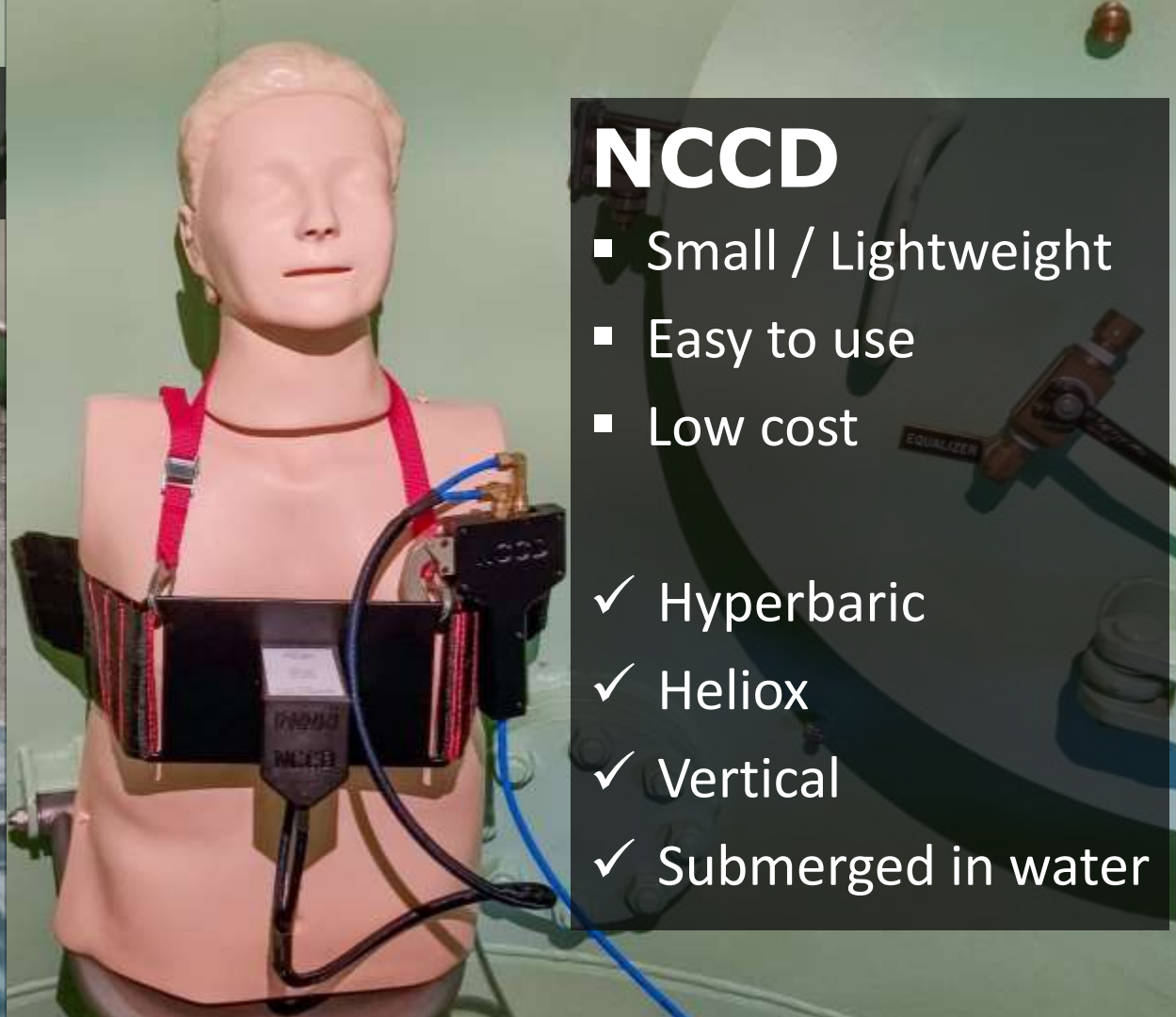

NCCD

- Small / Lightweight
 - Easy to use
 - Low cost
-
- ✓ Hyperbaric
 - ✓ Heliox
 - ✓ Vertical
 - ✓ Submerged in water

APPLICATION OF NUI COMPACT CHEST COMPRESSION DEVICE - NCCD



A. Undress the patient's upper body. Cut off clothes if needed.

B. Apply NCCD as shown in illustrations ①②③④.

! If proper application and use of NCCD is not possible, start manual CPR immediately.

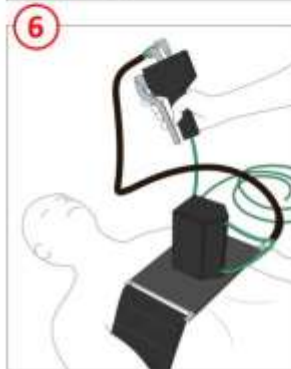

VERTICAL PATIENT - APPLY SUPPORT STRAP



nui

post@nui.no
www.nui.no/nccd

patent trademark design
**Norwegian Industrial
Property Office**



Patent approved
October 2021

nui

NCCD rental concept

- 12 months periods
- Service included

Recommendations DSV

- 1 unit in each bell
- 1 unit in each TUP
- 1 training unit

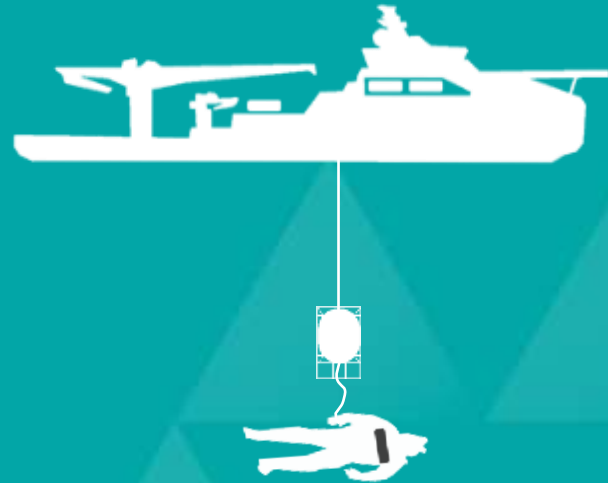

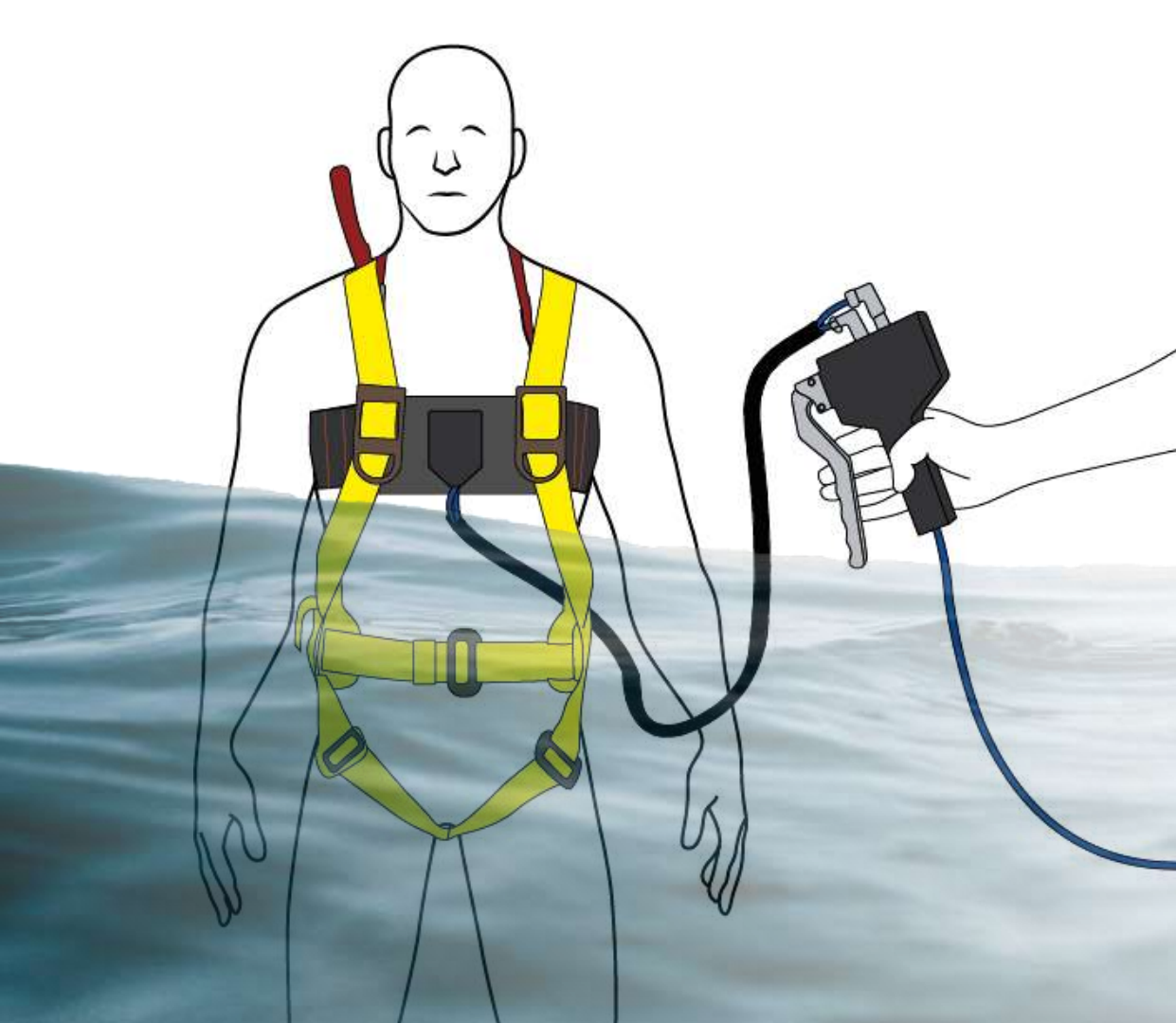

NUI COMPACT CHEST COMPRESSION DEVICE

nui